



M-Series Quick Start Guide

Power Button

- Press and hold to power On/Off
- Press to dim

Menu Button

- Press to enable menu
- Press to exit menu

Scene Button

- Press to change scene settings
- Press and hold to switch between visible and thermal cameras

LCD Display

- Displays Startup/Shutdown options
- Use puck to interact

User Programmable Button

- Press and hold to display options

Home Button

- Press and hold until icon flashes to store home
- Press to return to home position

Color Button

- Press to change color pallet (thermal only)

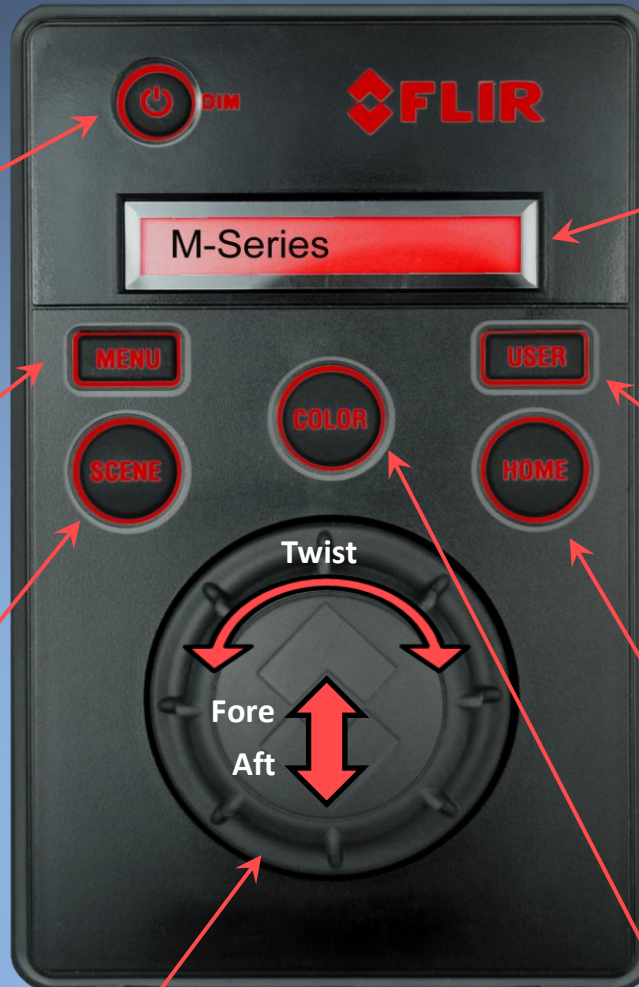

Puck

- Twist to rotate camera
 - Push fore/aft to tilt camera
- ### To Zoom and Freeze Picture
- Press down and hold to zoom in
 - Pull up and hold to zoom out
 - Double click to freeze image
 - Any action unfreezes image
- ### To Navigate On-Screen Menus
- Push fore/aft or twist to scroll up/down
 - Press down to accept menu item
- ### To Navigate LCD Menu
- Push fore/aft to scroll up/down
 - Press puck to accept menu item



M-Series Quick Start Guide



Position Indicator





Home Position

Controllers on Network

PC on Network

Scene Icons
MOB,
Night Running,
Daytime Running,
Night Docking

Rearview, Zoom ,
Image Frozen

-  Permanent Icons: Displayed in "minimal" or "all" icon mode
-  Persistent Icons: Displayed persistently when enabled
-  Momentary Icons: Momentarily displayed in "minimal" or "all" icon mode
-  Selectable Icons: Displayed only in "all" icon mode